

IMPORTANT!

- Make sure all specifications and instructions are followed carefully.
- Floor covering exclusively for interior residential use.
- Contact your Tarkett retailer if you are unsure about any part of the installation.
- Use the same batch number in the same room, and in sequential rolls order.
- Store the 2m rolls upright in a safe position and the 3 or 4m rolls laid on the floor.
- Let the flooring sheets acclimatise and relax at least 24h before installation.
- The subfloor must be flat, level, clean, without marks (no felt pen, marker, etc.), sound, dry, solid, hard, smooth and not exposed to moisture (humidity rising). Absorbency must be checked.
- Use only adhesives recommended by Tarkett. Always follow the adhesive manufacturer's instructions.
- The work must be completed with a thorough cleaning and make sure that the newly laid floor is free from adhesive residues.
- *This information is subject to change due to continuous improvement.*

TOOLS AND EQUIPMENT

- Cutter
- Measuring tape
- Metal ruler
- Debeader
- Pencil (never use marker or felt pen)
- Safety gloves
- Pressing tool with rounded edge (to evacuate air under the flooring)

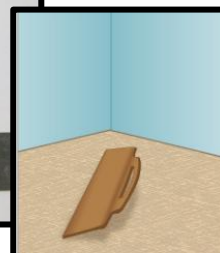

- According the installation:
 - Notched spatula (for glued installation)
 - Acrylic adhesive (for glued installation)
 - Double sided adhesive tape (for semi or loose laid installation)
 - With Tarkett Tarkospray adhesive: no need of spatula or tape!

INSTALLATION ON NEW SUBFLOOR

The subfloor must be level, flat, clean, free from marks (no felt pen, marker of any type, ballpoint pens, paint, etc., that could cause discoloration due to migration), dry, solid, smooth and not exposed to moisture. Absorbency must be checked and corrected if needed with an appropriate primer or levelling compound.

INSTALLATION ON EXISTING FLOORING

Plastic / linoleum coverings - ✓ possible installation: glued, semi or loose lay

RR may be laid directly onto compact and hard plastic coverings as well as onto linoleum. Existing flooring must be in good condition (no disbonding, no cracks...) and cleaned (grease and dust removed). RR is not recommended for installation on very flexible plastic coverings (textile or foam backing).

Textile coverings - ✗ no

RR is incompatible with carpet and other textile coverings. These must be removed before installation.

Parquet and laminate flooring (glued down and floating) - ✓ possible installation: loose lay or glued*

RR may be loose laid directly on laminate or parquet flooring either that has been glued down or that is floating, where there are no joints and the strips are not loose; any loose plank must be secured.

RR could be glued (after sanding and vacuuming existing wooden flooring) if moisture isn't blocked under.

* If there is a risk to block humidity in the subfloor, glued installation is not recommended.

Tiled flooring - possible installation: ✓ loose lay or glued****

** Installation on tiles could cause telegraphing effect (visible joints of tiling on the RR surface).

That's why RR is not recommended on tiling. A leveling compound has to be used first to ensure level and flatness. When joints are not visible, loose laying or gluing can be admitted. Grease and dust have to be removed.

CONDITIONS REQUIRED FOR INSTALLATION

It is important to lay cut sheets for at least 24 hours before installation at a minimum room temperature of 15°C. This temperature should be maintained throughout the installation.

The minimum temperature of the subfloor should be 10°C.

The recommended relative humidity inside the room should be 35-65%.

Sections of flooring must be cut to the required lengths, plus an allowance of a few centimetres (± 5 cm).

UNDERFLOOR HEATING

It is imperative that underfloor heating systems have been previously commissioned and found to be functioning correctly before installation of the floorcovering.

Ensure that the underfloor heating system is switched off 48 hours before installation of the floorcovering commences, and remains off for at least 48 hours after installation is completed. While the underfloor heating system is off, an alternative heating source should be provided, if required, to ensure that the installation area is kept at a constant temperature of 18-27°C.

Gradually increase the temperature over a number of days by only a few degrees per day until the desired room temperature is reached. The temperature should never exceed the floorcovering industry's agreed maximum of 27°C on the underside of the floorcovering (the adhesive line).

▲ In case of underfloor heating, installation should not be done over an existing flooring, it means that flooring should be scrapped and subfloor prepared to welcome the new installation.

LAYING DIRECTION

Plan the sheet direction for the area to be installed to ensure whenever possible that joins do not coincide with doorways, main traffic lanes. If the room is reasonably square, the sheets should run parallel to the incoming light. In long, narrow rooms (like corridors) you can install the sheets along the length of the room.

! IMPORTANT !

All consecutive sheets should be installed in the opposite direction to the previous sheet installed, except for wood designs, which are installed in the same direction (always refer to the product description)

LOOSE LAYING INSTALLATION

Regarding semi and loose laid installation, double sided tape adhesive is used to keep the flooring in place and also to ease the installation (trimming edges in the perimeter). In case you will install skirting after flooring installation, tape on the perimeter is not mandatory. In case of already existing skirting, we recommend to use tape on the perimeter. **Full loose lay may be used only for very light traffic (no furniture movement, no rolling load), and if there is no risk of slippery between existing flooring or subfloor and the backing of installed flooring.**

❖ For room of max. 25m² with only one sheet (4m large products) and very light traffic:

> Fully loose lay possible: lay your vinyl floor (sheet should be cut to the required lengths, plus an allowance of a few centimetres) on the prepared subfloor and smooth out any and all extra air from the center to the edges with the pressing tool. Cut off (trim) extra material along the walls with cutter or debader. Install skirting all around to cover the cuts.

> In case of existing skirting: install double sided tape adhesive on the perimeter, lay your vinyl floor on the prepared subfloor. Fold the 4 sides and remove the protective paper of the tape, fold back side by side, smoothing out any and all extra air from one side to the other with the pressing tool and stick your flooring. Cut off (trim) extra material along the walls with cutter or debader.

❖ **For room with 2 sheets or more and very light traffic:**

> Semi loose lay **with double sided adhesive tape under the joint.**

- Place reference points in the room where the 2 sheets will join.

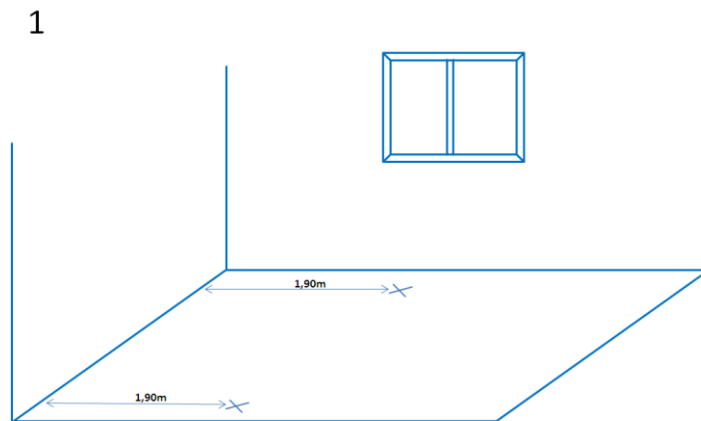

- Place the sheets and overlap them to perform a double cut.

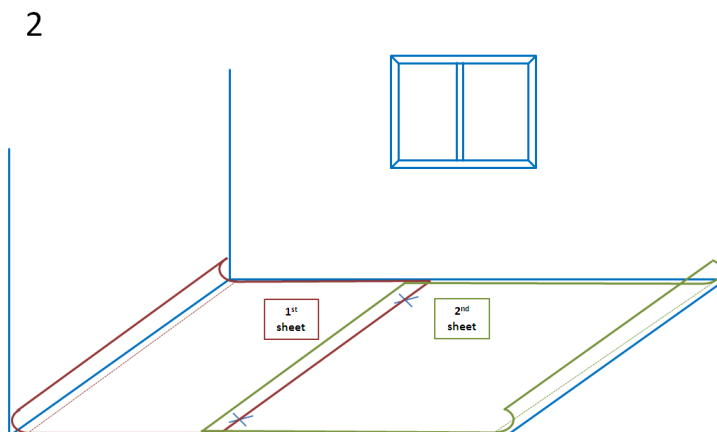

- Trace a reference line along the cut sheet.

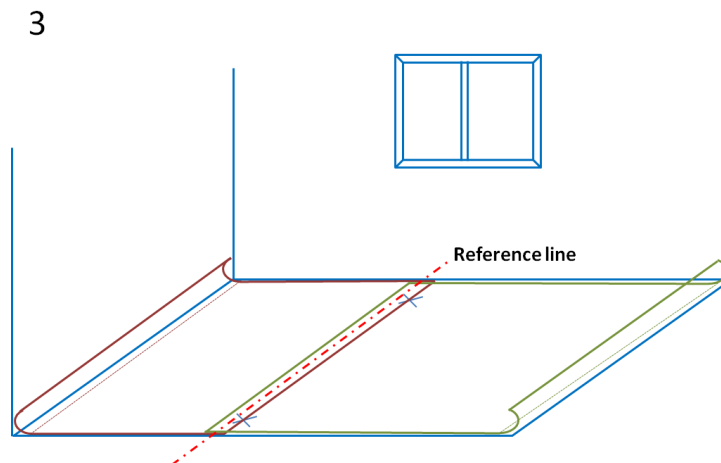

- Fold the sheets and place the tape over this line.

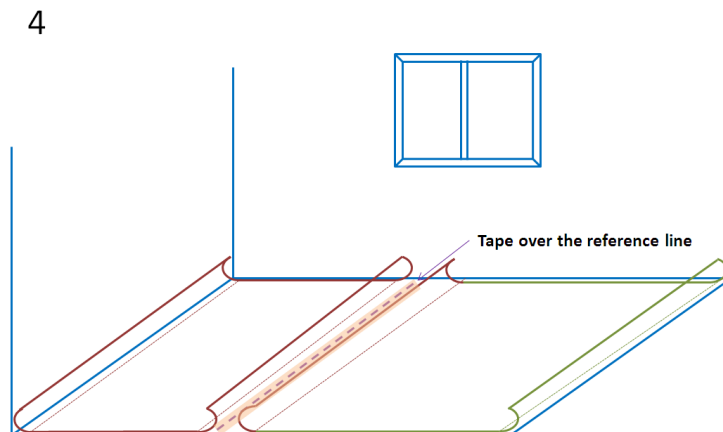

- Remove the protective paper, fold back and stick the 2 sheets.

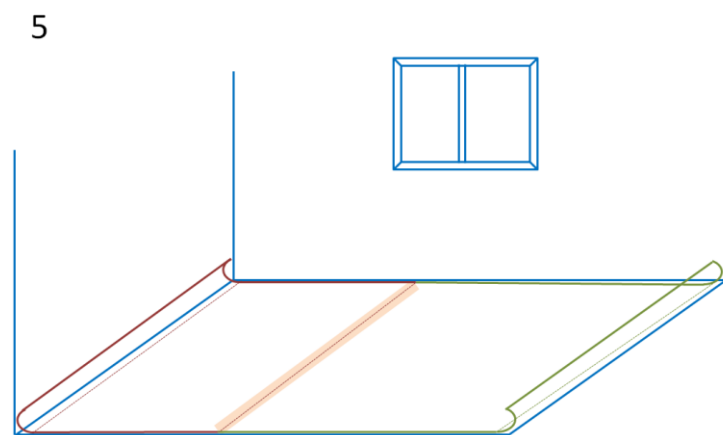

- Smooth out any and all extra air from the center to the edges with the pressing tool.
- Cut off (trim) extra material along the walls with cutter or debader. Install skirting all around to cover the cuts.

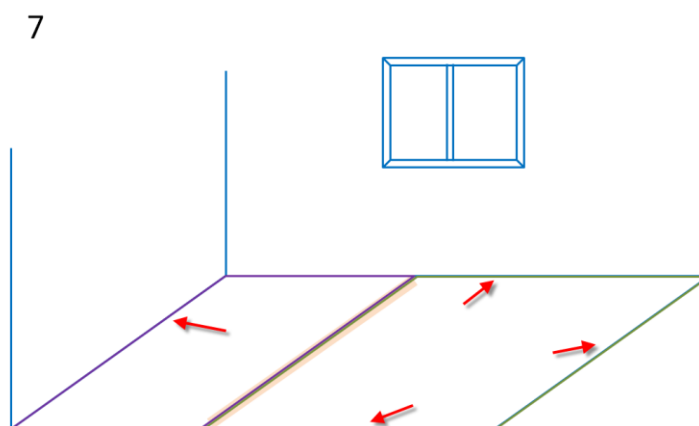

In case of existing skirting: install double sided tape adhesive on the perimeter as a first step, remove the protective paper and stick your flooring after the joint sealing.

❖ **For room of more than 25m² with 2 sheets or more and medium traffic:**

> Semi loose lay with **double sided tape on the perimeter and under the joint.**

- Place reference points in the room where the 2 sheets will join.

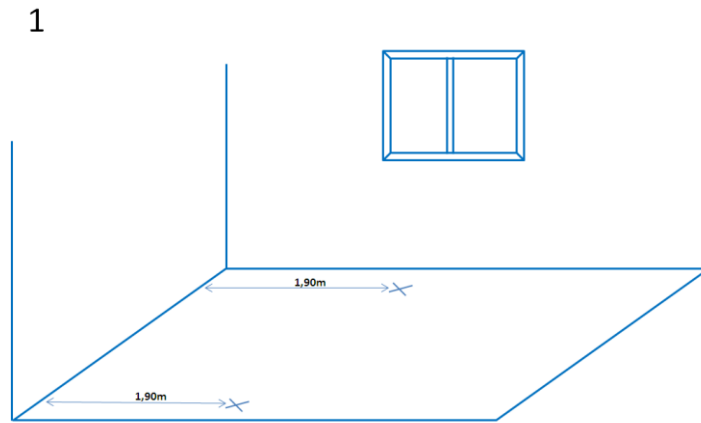

- Place the tape on the entire perimeter (do not remove the protective paper on the top)

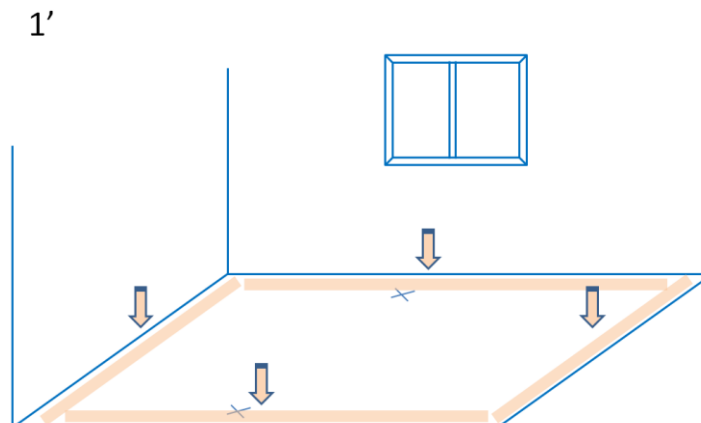

- Place the sheets and overlap them to perform a double cut. Pay attention to the direction!

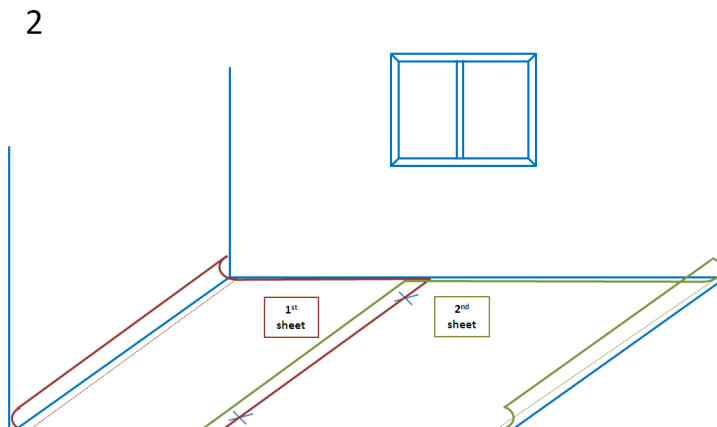

- Trace a reference line along the cut sheet.

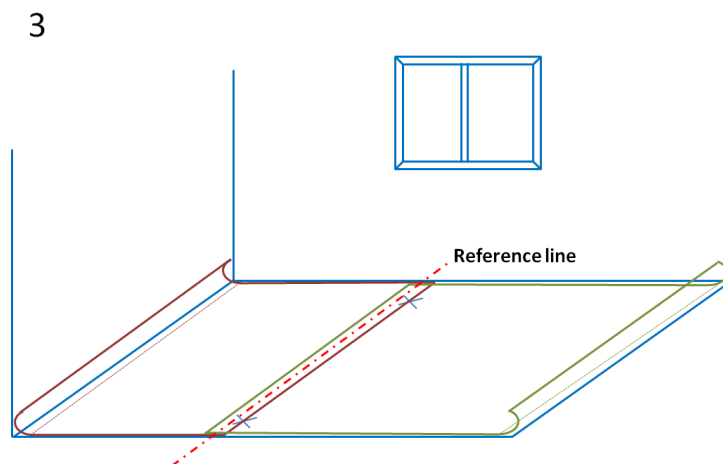

- Fold the sheets and place the tape over this line.

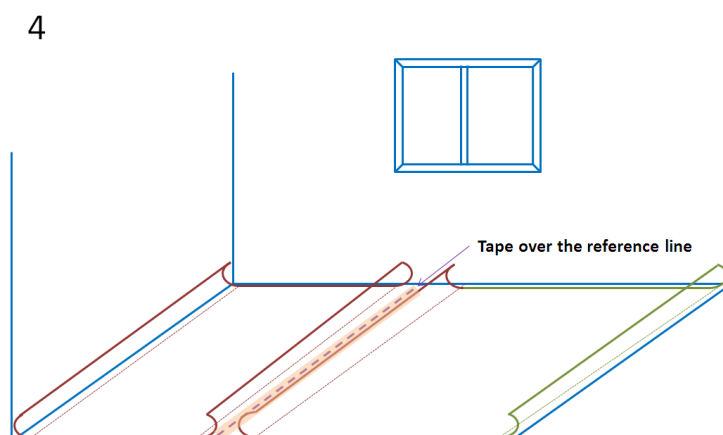

- Remove the protective paper, fold back and stick the 2 sheets. Remove the extra.

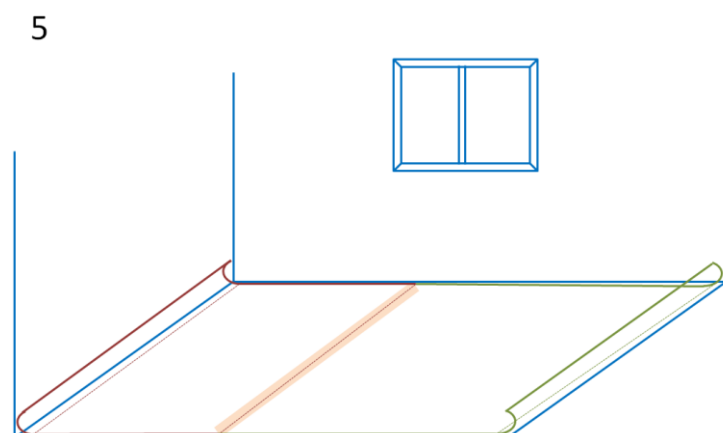

The PRO advice:

When needed, you can seal the joint with a cold welding solution (see related instruction)



- Fold the 4 sides and remove the protective paper of the tape placed on the perimeter, fold back side by side, smoothing out any and all extra air from one side to the other with the pressing tool and stick your flooring.

6

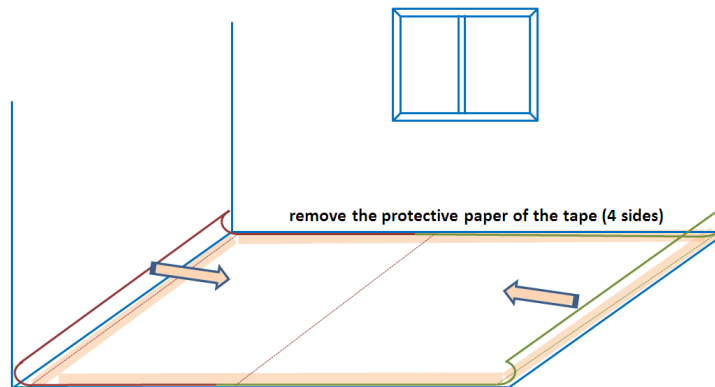

- Cut off (trim) extra material along the walls with cutter or debader.

7

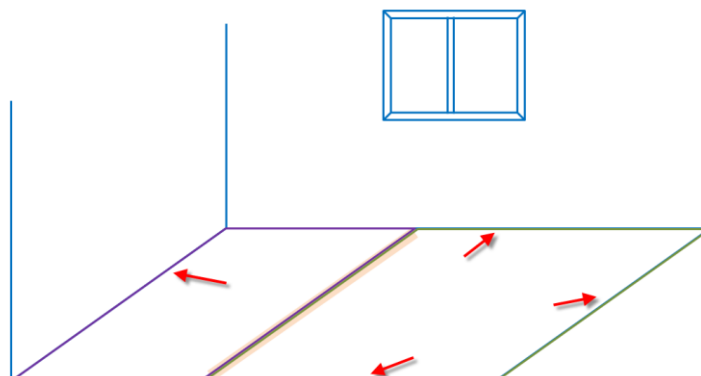

GLUING INSTALLATION

In case of significant traffic, it is also possible to glue the installation with an acrylic adhesive applied with notched spatula or to use Tarkospray (see related instruction).



- > Place reference points in the room where the 2 sheets will join
- > Place the sheets and overlap them to perform a double cut. At this step the flooring should be flat (no wave along the joint).
- > Trace the reference line along the cut sheet. Fold the sheets on half and apply the acrylic adhesive. Let the adhesive become tacky (respect waiting time, follow manufacturer instructions).
- > Fold back the sheets into the adhesive, along the reference line and smooth out any and all extra air from the center to the edges with the pressing tool. Do it in the same way for the second half. Cut off (trim) extra material along the walls with cutter or debader.
- > For more details on glued installation, please refer to the specific installation instruction.

⇒ **These instructions are also valid when installing only 1 sheet.**

AFTER INSTALLATION

! IMPORTANT !

**Wait 48 to 72 hours before allowing any foot traffic or moving in furniture (according to adhesive manufacturer's instructions).
For loose lay and Tarkospray installation,
you can walk on your new flooring just after completing the installation.**

If building work is carried out after installation, the floor should always be protected by covering it with hardboard or plywood sheeting. Masking tape must not be stuck directly to the floor.

INITIAL CLEANING

It is always recommended to proceed to a thorough cleaning before using your new flooring.

Residual adhesive should be removed with methylated spirits and a clean cloth.

Lightly soiled floors: vacuum, sweep or damp mop the area to remove loose dirt and building dust.

For semi-professional sites and use, a combined machine is very effective for large areas (combined scrubber/dryer with cylindrical brushes for safety flooring).

MAINTENANCE AND CARE

- > Clean the floorcovering regularly, as this is more cost-effective and hygienic than occasional heavy-duty cleaning.
- > Always follow dosage instructions carefully
- > Wipe up any grease and spilt oil immediately, as they may damage the surface
- > Treat stains immediately; spot clean by hand with a nylon pad and neutral detergent, work from the outside of the mark towards its centre. Rinse and wipe afterwards with clean water
- > Resilient floors are damaged by solvents and abrasive powders
- > All chair and table legs should have good quality protective pads (felt or plastic)
- > Remember that light colours need more frequent cleaning
- > Use entrance matt
- > Daily and regular cleaning:
 - Dry mop or vacuum the floor to eliminate dust and dry soiling
 - Damp mop with diluted neutral detergent to eliminate soiling when needed

